

## Café-Barriers



### Sizes Available (width) ↗

100cm Cross Rail

150cm Cross Rail

200cm Cross Rail

### Recommended

Singled Sided Aero Mesh

Single / Double Sided PVC

Canvas

## ASSEMBLY INSTRUCTIONS

Remove all products from packaging.

1

Attach the threaded bottom part of the post to the base by aligning it with the central hole, pushing through and tightening with the washer and nut provided.

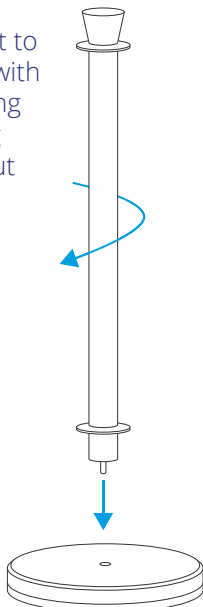

2

To attach your graphic, slide the cross rail(s) through the top and bottom pole pockets on your graphic until central.

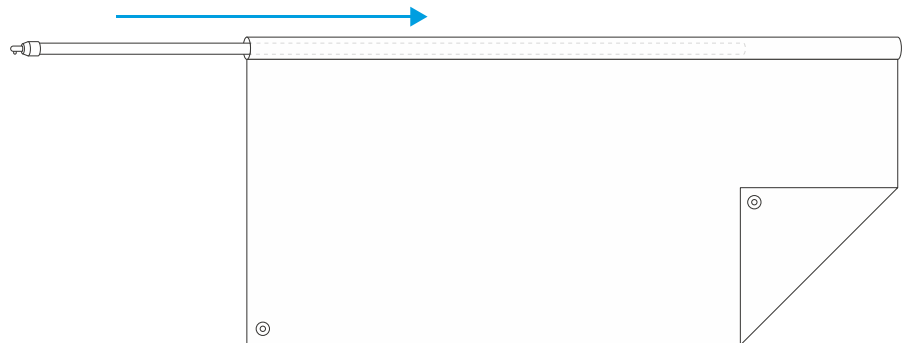

**Note:** If you are using a cross rail at the top and springs at the bottom, there will be a pocket at the top and eyelets at the bottom.

## ASSEMBLY INSTRUCTIONS

---

3

Slot the hooks on the ends of the cross rails into the holes on the top and bottom of the rings on the poles.

**Note:** If you are using springs at the bottom, simply attach the eyelets to the bottom of the pole with the elastic provided.



4

Once the main unit is assembled, repeat the process to form a line of café banners.

